

CTS REAR ENGINE



CHAMPION
BUS, INC.
Thor Industries Commercial Bus Division

Standard Features

Chassis

- Dual Batteries
- Tilt Steering Wheel-Cruise Control
- 270 Amp Alternator
- Power Brakes - Anti-Lock
- Power Steering
- Radial Tires
- Super Engine Cooling
- External Transmission Cooler
- Intermittent Wiper

Conversion

- Aluminum rub rail
- Battery box w/slide tray
- Body is square, plumb, and level prior to being mounted on OEM chassis.
- Ceiling, padded vinyl
- Corrosion-protected entry step well and wings
- Electric passenger entry door with exterior key switch
- Electrical Panel
- Exterior, White
- Fiberglass Front Cap
- 5/8" Plywood
- Front and rear mud flaps
- Insulation, Foamed in Place
- Interior Lighting, 12V Lights, Stepwell
- Luggage Door, STD on Luggage Models
- Mirrors, Sideview
- Modesty Panel At Entry
- Multiplex Wiring
- Paratransit Door STD Lift Models
- Rear Steel Bumper
- Right hand grab rail
- Track Seating
- Roof, Painted Galvanized Steel Sidewalls, Ext. Galvanized Steel Stanchion, Stainless Steel SteelGuard® Construction-Floor, Roof, Sidewalls
- Undercoating, Floor Frame
- Wheelwells, Steel
- Windows, Tinted T-Slider-Top
- Gray floor rubber covered to seat track
- Ziebart undercoating



Convenient driver controls are easily accessible.



A variety of seating packages are available.



Available in 96" or 102" wide body widths for seating flexibility.

NOTE: Champion Bus Inc. reserves the right to make changes at any time in prices, colors, materials, equipment, design specifications and models, and also to discontinue models without notice and/or obligations. Data shown is basic information for the prospective buyer effective at the time of issuance of this literature. Dealer will provide complete up-to-date information on available equipment specifications, etc., not shown here. Items referred to as "options" or are "available" are at extra cost.

TS Rear Engine			
	CTS-RE30	CTS-RE34	CTS-RE38
Chassis	Freightliner XB 55	Freightliner XB 75	Freightliner XB 75
Engine	Cummins ISB 07 6.7L 200-300HP	Cummins ISB 07 6.7L 200-300HP	Cummins ISB 07 6.7L 200-300HP
Transmission	2000 Series	B300 Series	B300 Series
Tires	235/80R 22.5	275/80R 22.5	275/80R 22.5
Wheelbase	160"	208"	252"
GVWR	26,350#	32,000#	32,000#
Length*	32'-8"	36'-8"	40'-4"
Exterior Height** (add 5" for 102" wide)	122"	122"	122"
Exterior Width	96" or 102"	96" or 102"	96" or 102"
Interior Height (add 5" for 102" wide option)	78"	78"	78"
Interior Width (96.5" on 102" wide option)	90"	90"	90"

* add 4.5" for escape hatch and 6" for destination sign

** length measured with standard bumpers

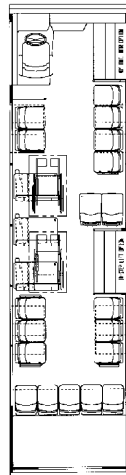

MODEL CT-300
21-Passenger
Paratransit

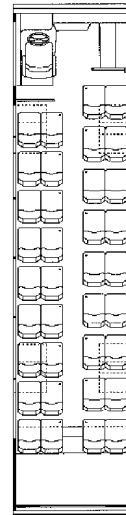

MODEL CT-340
36-Passenger

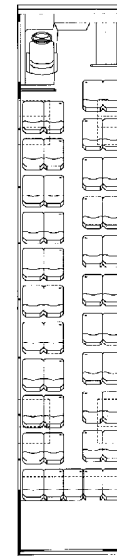

MODEL CT-380
45-Passenger

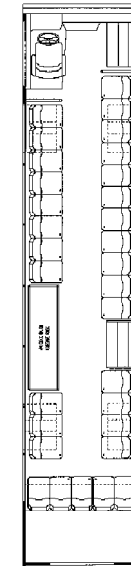

MODEL CT-380
31-Passenger
Perimeter Seating

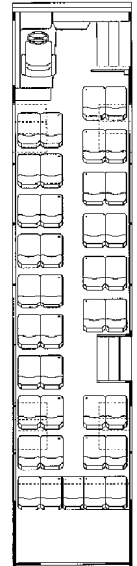

MODEL CT-380
39-Passenger
2 Doors



www.creativebussales.com
sales@creativebussales.com
(800) 326-2877



Creative Bus Sales
El Dorado Bus Sales